

REV	SYL	DESCRIPTION	DATE	REV'D	APP'D

DPO 210 HYDRAULIC POWER TAKE OFF SPECIFICATION

GEAR RATIO	ONLY 1 : 1
TOTAL WEIGHT	APPROX. 250 kg(DRY)
OIL CAPACITY	APPROX. 5 L
OIL VISCOSITY	SAE # 30
OIL PRESSURE	1.56 ~ 2.45 MPa
CLUTCH OIL	CLUTCH OIL
INPUT DIRECTION OF ROTATION	THE SAME DIRECTION AS ENGINE ROTATION
OUTPUT DIRECTION OF ROTATION	THE SAME DIRECTION AS ENGINE ROTATION
OIL CHANGE INTERVAL	THE FIRST 100HOURS OF INITIAL OPERATION AND EVERY 1000HOURS THEREAFTER
SHIFTING LIMIT	UNDER 50% OF THE RATED ENGINE SPEED
OIL COOLER	WATER FLOW 40 ~ 60L/min TEMPERATURE OF COOLING WATER MAX. 32°C

ROTATION DIRECTION BY MODEL (VIEWED FROM B)

MODEL	INPUT (ENGINE)	OUTPUT (PTO)
DPO-F210S	(RIGHT)	(RIGHT)
DPO-R210S	(LEFT)	(LEFT)

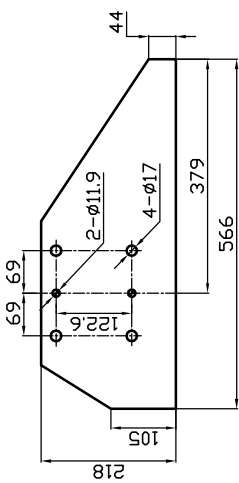
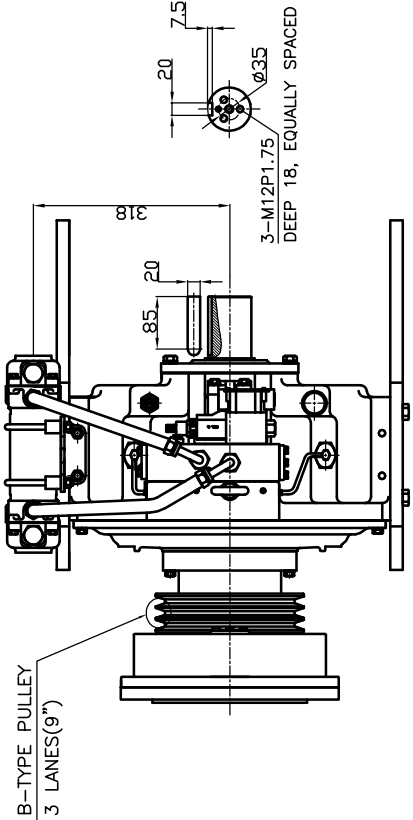

SOLENOID VALVE
DC24V

EMERGENCY KNOB

ACTION PRESSURE
GAUGE PORT
(PT 1/8-28)

4-M16P2.0
DEEP 26

VIEWED FROM B

DRAIN PLUG
M16P1.5
(MAGNET PLUG)

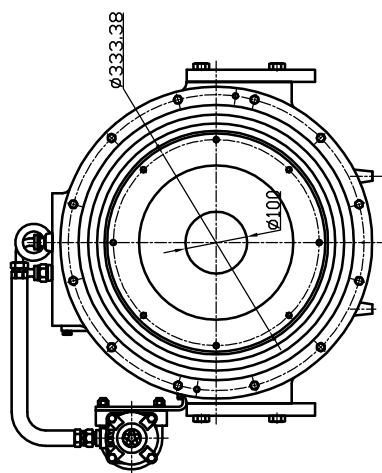

OIL INLET AND AIR BREATHER

REMARK

- STANDARD SPECIFICATION
- DRIVING RING: DUMMY PLATE INCLUDING SAE 11.5"
- OUTPUT SHAFT SPEC: SHAFT Ø70_ KEY 20mm*95mm

REVISIONS	NO.	DATE	BY	REASON

NO.	PART NO.	PART NAME	SIZE	REMARK

MATERIAL	TYPE	SCALE	DATE
DPO-F(R)210S	1/1	1/1	2013.02.05

APPROVED BY	DESIGNED BY	NAME	DWG. NO.

SIZE	CODE IN NO.
A0	

PTO INSTALLATION DRAWING
T 210 F(R)SSG

D-I INDUSTRIAL