

NO.	SYMBOL	DESCRIPTION	POSITION	REVISION NO.	DATE	REV'D	APP'D

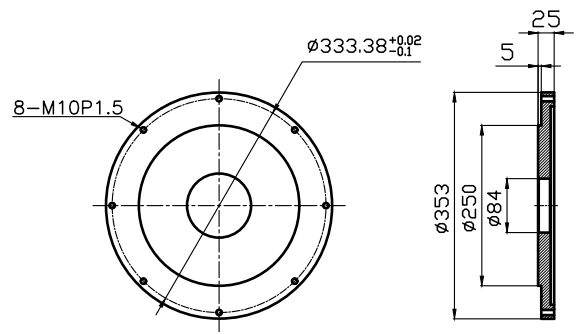

STANDARD : DUMMY PLATE  
[MANUFACTURE THIS PLATE FOR ENGINE PULLEY]

OIL INLET AND AIR BREATHER

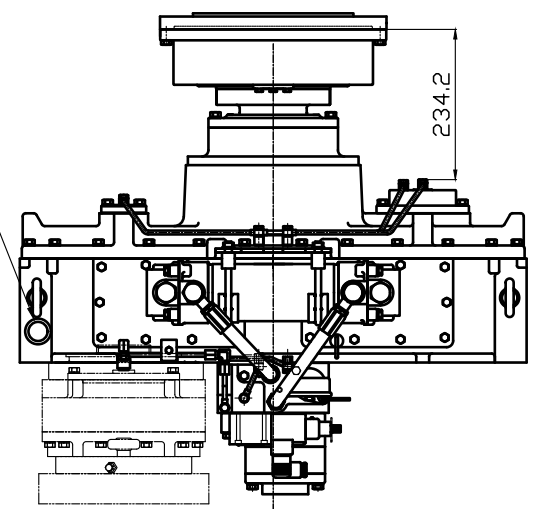

GEAR RATIO	0.6607:1, 0.9787:1, 0.7692:1(중속)		
TOTAL WEIGHT	APPROX. 420 kg(DRY)		
OIL CAPACITY	APPROX. 7 L		
OIL VISCOSITY	SAE # 30		
OIL PRESSURE	16 ~ 25 kg/cm <sup>2</sup>	CLUTCH OIL	
DIRECTION OF ROTATION IN FORWARD	INPUT	C.C.W VIEWED FROM THE STERN	
OIL CHANGE INTERVAL	OUTPUT	C.W VIEWED FROM THE STERN	
SHIFTING LIMIT	THE FIRST 100HOURS OF INITIAL OPERATION AND EVERY 1000HOURS THEREAFTER		
OIL COOLER	UNDER 50% OF THE RATED ENGINE SPEED		
	WATER FLOW 40 ~ 60L/min		TEMPERATURE OF COOLING WATER MAX 32°C

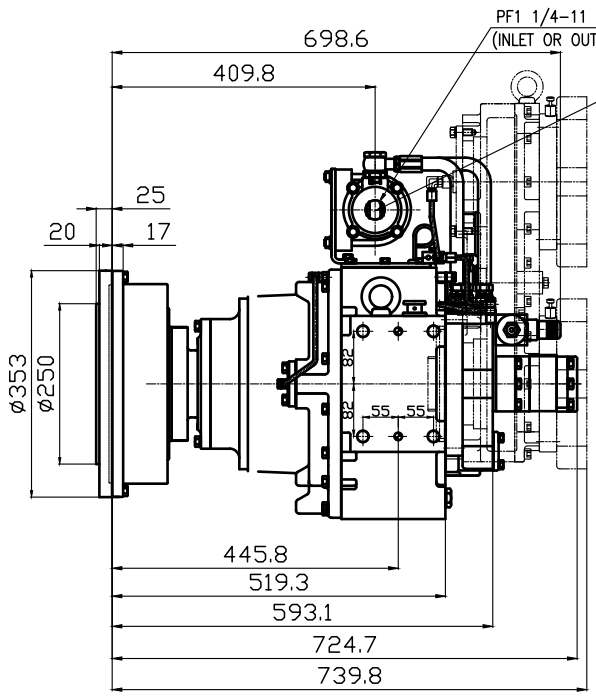

PF1 1/4-11 BOTH SIDES (INLET OR OUTLET OF COOLING WATER)

ZINC ANODE  
SOLENOID VALVE DC24V

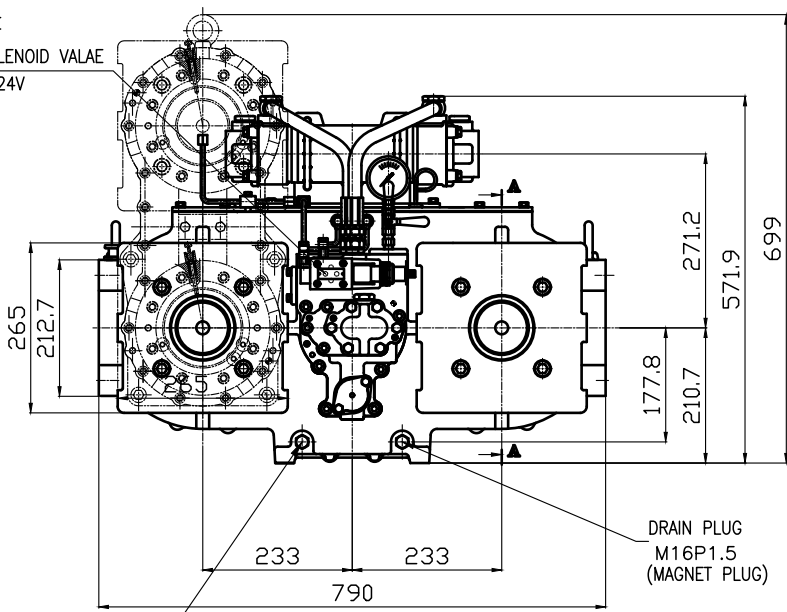

M16P1.5 DRAIN PLUG

DRAIN PLUG M16P1.5 (MAGNET PLUG)

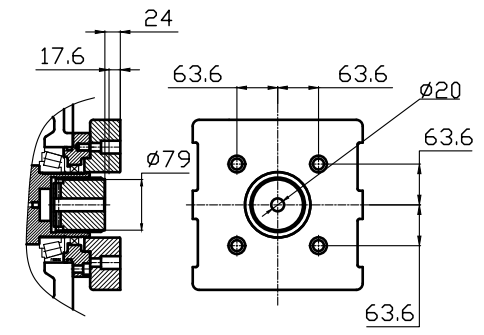

단면 A-A

- REMARK
1. STANDARD SPECIFICATION
  2. DRIVING RING: DUMMY PLATE INCLUDING SAE 11.5"
  3. SIZE OF PUMP FLANGE MAY BE CHANGED DEPENDING ON PUMP SPEC.
  4. GEAR BOX TYPE (3PUMP)

NO.	PART NO.	PART NAME	QTY	MATERIAL	SIZE	REMARKS

TOLERANCE ON FRACTIONS DECIMALS ANGLES ± 0.1 ± 0.05 ± 0.1 ± 0.2 ± 0.07 ± 0.2 ± 0.3 ± 0.1 ± 0.3 ± 0.5 ± 0.2 ± 0.5 ± 1.0 ± 0.5 ± 1.0	MATERIAL 주기 1 합조 DATE 2013.01.10 SCALE N/S APPROVED BY CHECKED BY DRAWN DESIGNED	TYPE DPO-F(R)410 NAME PTO 거치도면 DWG. NO. T410F(R)A~DPGS-L 크기 A0 CODE ID. NO.
--	---	--